

# Feed-through terminal block - ST 1,5-QUATTRO

3031186

<https://www.phoenixcontact.com/de/produkte/3031186>

Please be informed that the data shown in this PDF document is generated from our Online Catalog. Please find the complete data in the user documentation. Our General Terms of Use for Downloads are valid.

---

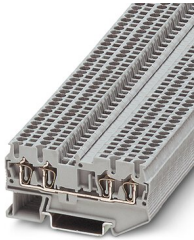

Feed-through terminal block, nom. voltage: 500 V, nominal current: 17.5 A, connection method: Spring-cage connection, 1 level, Rated cross section: 1.5 mm<sup>2</sup>, cross section: 0.08 mm<sup>2</sup> - 1.5 mm<sup>2</sup>, mounting type: NS 35/7,5, NS 35/15, color: gray

---

## Your advantages

- Cross connection to any number of terminal blocks with the consistent FBS ... plug-in bridge system
- Compact potential distributors, the double connection enables four conductors to be connected on one potential
- Tested for railway applications

# Feed-through terminal block - ST 1,5-QUATTRO



3031186

<https://www.phoenixcontact.com/de/produkte/3031186>

## Commercial Data

Item number	3031186
Packing unit	50 pc
Minimum order quantity	1 pc
Sales Key	A1 - Reihenklennen
Product Key	BE2113
Catalog Page	Page 207 (C-1-2019)
GTIN	4017918186678
Weight per Piece (including packing)	7,706 g
Weight per Piece (excluding packing)	7,18 g
Customs tariff number	85369010
Country of origin	DE

# Feed-through terminal block - ST 1,5-QUATTRO



3031186

<https://www.phoenixcontact.com/de/produkte/3031186>

## Technical Data

### Notes

#### General

Note	When establishing a connection on the open housing side of a feed-through modular terminal block of the same series and size, the block must be provided with a cover if the expected insulation voltage is >320 V.
	The max. load current must not be exceeded by the total current of all connected conductors.

### Product properties

Product type	Multi-conductor terminal block
Area of application	Railway industry
	Machine building
	Plant engineering
	Process industry
Number of connections	4
Number of rows	1
Potentials	1

#### Insulation characteristics

Overvoltage category	III
Degree of pollution	3

### Electrical properties

Rated surge voltage	6 kV
Maximum power dissipation for nominal condition	0.56 W

### Connection data

Number of connections per level	4
Nominal cross section	1.5 mm <sup>2</sup>

#### 1 level

Stripping length	8 mm ... 10 mm
Internal cylindrical gage	A1
Conductor cross section solid	0.08 mm <sup>2</sup> ... 1.5 mm <sup>2</sup>
Cross section AWG	28 ... 16
Conductor cross section flexible	0.08 mm <sup>2</sup> ... 1.5 mm <sup>2</sup>
Conductor cross section, flexible [AWG]	28 ... 16
Flexible conductor cross section flexible (ferrule, w/o plastic sleeve)	0.14 mm <sup>2</sup> ... 1.5 mm <sup>2</sup>
Flexible conductor cross section (ferrule with plastic sleeve)	0.14 mm <sup>2</sup> ... 1.5 mm <sup>2</sup>
2 conductors with the same cross section, flexible, with TWIN ferrule with plastic sleeve	0.5 mm <sup>2</sup>
Nominal current	17.5 A (with 1.5 mm <sup>2</sup> conductor cross section)

# Feed-through terminal block - ST 1,5-QUATTRO



3031186

<https://www.phoenixcontact.com/de/produkte/3031186>

Maximum load current	17.5 A (in case of a 1.5 mm <sup>2</sup> conductor cross section, the maximum load current must not be exceeded by the total current of all connected conductors.)
Nominal voltage	500 V
Nominal cross section	1.5 mm <sup>2</sup>

## Ex data

### Rated data (ATEX/IECEX)

ATEX certificate	KEMA 01 ATEX 2129 U
IEC Ex certificate	IECEX KEM 06.0043 U
Identification	□ II 2 GD Ex eb IIC Gb
Operating temperature range	-60 °C ... 110 °C
Ex-certified accessories	3030514 D-ST 2,5-QUATTRO 3030815 ATP-ST QUATTRO 3036602 DS-ST 2,5 1204504 SZF 0-0,4X2,5 3022276 CLIPFIX 35-5 3022218 CLIPFIX 35
Bridge data	16.5 A / 1.5 mm <sup>2</sup>
Ex temperature increase	40 K (19.7 A / 1.5 mm <sup>2</sup> )
Rated voltage	400 V
for bridging with bridge	440 V
- At bridging between non-adjacent terminal blocks	352 V
- At bridging between non-adjacent terminal blocks via PE terminal block	352 V
- At cut-to-length bridging with cover	220 V
- At cut-to-length bridging with partition plate	275 V
Rated insulation voltage	400 V

### Ex level General

Rated current	17.5 A
Maximum load current	17.5 A
Contact resistance	1.54 mΩ

### Ex connection data General

Nominal cross section	1.5 mm <sup>2</sup>
Rated cross section AWG	16
Connection capacity rigid	0.08 mm <sup>2</sup> ... 1.5 mm <sup>2</sup>
Connection capacity AWG	28 ... 16
Connection capacity flexible	0.08 mm <sup>2</sup> ... 1.5 mm <sup>2</sup>
Connection capacity AWG	28 ... 16

## Dimensions

Width	4.2 mm
End cover width	2.2 mm

# Feed-through terminal block - ST 1,5-QUATTRO



3031186

<https://www.phoenixcontact.com/de/produkte/3031186>

Height NS 35/15	44 mm
Height NS 35/7,5	36.5 mm
Height	1.437 "
Length	72 mm

## Material specifications

Color	gray
Flammability rating according to UL 94	V0
Insulating material group	I
Insulating material	PA
Static insulating material application in cold	-60 °C
Temperature index of insulation material (DIN EN 60216-1 (VDE 0304-21))	125 °C
Relative insulation material temperature index (Elec., UL 746 B)	130 °C
Fire protection for rail vehicles (DIN EN 45545-2) R22	HL 1 - HL 3
Fire protection for rail vehicles (DIN EN 45545-2) R23	HL 1 - HL 3
Fire protection for rail vehicles (DIN EN 45545-2) R24	HL 1 - HL 3
Fire protection for rail vehicles (DIN EN 45545-2) R26	HL 1 - HL 3
Calorimetric heat release NFPA 130 (ASTM E 1354)	27,5 MJ/kg
Surface flammability NFPA 130 (ASTM E 162)	passed
Specific optical density of smoke NFPA 130 (ASTM E 662)	passed
Smoke gas toxicity NFPA 130 (SMP 800C)	passed

## Electrical tests

### Surge voltage test

Test voltage setpoint	7.3 kV
Result	Test passed

### Temperature-rise test

Requirement temperature-rise test	Increase in temperature $\leq$ 45 K
Result	Test passed
	Test passed
Short-time withstand current 1.5 mm <sup>2</sup>	0.18 kA
Result	Test passed

### Power-frequency withstand voltage

Test voltage setpoint	1.89 kV
Result	Test passed

## Mechanical properties

### Mechanical data

Open side panel	Yes
-----------------	-----

## Mechanical tests

# Feed-through terminal block - ST 1,5-QUATTRO



3031186

<https://www.phoenixcontact.com/de/produkte/3031186>

## Mechanical strength

Result	Test passed
--------	-------------

## Attachment on the carrier

DIN rail/fixing support	NS 32/NS 35
Test force setpoint	1 N
Result	Test passed

## Test for conductor damage and slackening

Rotation speed	10 (+/- 2) rpm
Revolutions	135
Conductor cross section/weight	0.08 mm <sup>2</sup> / 0.1 kg 1.5 mm <sup>2</sup> / 0.4 kg
Result	Test passed

## Environmental and real-life conditions

### Aging

Temperature cycles	192
Result	Test passed

### Needle-flame test

Time of exposure	30 s
Result	Test passed

### Oscillation/broadband noise

Specification	DIN EN 50155 (VDE 0115-200):2018-05
Spectrum	Service life test category 2, bogie-mounted
Frequency	$f_1 = 5 \text{ Hz}$ to $f_2 = 250 \text{ Hz}$
ASD level	6.12 (m/s <sup>2</sup> ) <sup>2</sup> /Hz
Acceleration	3.12g
Test duration per axis	5 h
Test directions	X-, Y- and Z-axis
Result	Test passed

### Shocks

Specification	DIN EN 50155 (VDE 0115-200):2008-03
Pulse shape	Half-sine
Acceleration	5g
Shock duration	30 ms
Number of shocks per direction	3
Test directions	X-, Y- and Z-axis (pos. and neg.)
Result	Test passed

### Ambient conditions

Ambient temperature (operation)	-60 °C ... 105 °C (max. short-term operating temperature RTI Elec.)
---------------------------------	---

# Feed-through terminal block - ST 1,5-QUATTRO



3031186

<https://www.phoenixcontact.com/de/produkte/3031186>

Ambient temperature (storage/transport)	-25 °C ... 60 °C (for a short time, not exceeding 24 h, -60 °C to +70 °C)
Ambient temperature (assembly)	-5 °C ... 70 °C
Ambient temperature (actuation)	-5 °C ... 70 °C
Permissible humidity (storage/transport)	30 % ... 70 %

## Standards and regulations

Connection in acc. with standard	IEC 60947-7-1
----------------------------------	---------------

## Mounting

Mounting type	NS 35/7,5
	NS 35/15

# Feed-through terminal block - ST 1,5-QUATTRO

3031186

<https://www.phoenixcontact.com/de/produkte/3031186>

## Drawings

Circuit diagram





# Feed-through terminal block - ST 1,5-QUATTRO



3031186

<https://www.phoenixcontact.com/de/produkte/3031186>

## Approvals

 <b>CSA</b> Approval ID: 13631				
	Nominal Voltage $U_N$	Nominal Current $I_N$	Cross Section AWG	Cross Section $mm^2$
Use group B	300 V	15 A	26 - 14	-
Use group C	300 V	15 A	26 - 14	-

 <b>IECEE CB Scheme</b> Approval ID: DE1-63027				
	Nominal Voltage $U_N$	Nominal Current $I_N$	Cross Section AWG	Cross Section $mm^2$
			-	-

 <b>LR</b> Approval ID: LR2014888TA				
	Nominal Voltage $U_N$	Nominal Current $I_N$	Cross Section AWG	Cross Section $mm^2$
			-	-

 <b>KR</b> Approval ID: HMB17372-EL002				
--	--	--	--	--

 <b>NK</b> Approval ID: 09 ME 140				
	Nominal Voltage $U_N$	Nominal Current $I_N$	Cross Section AWG	Cross Section $mm^2$
			-	-

 <b>RS</b> Approval ID: 17.00013.272				
--	--	--	--	--

 <b>BV</b> Approval ID: 13403/D0 BV				
	Nominal Voltage $U_N$	Nominal Current $I_N$	Cross Section AWG	Cross Section $mm^2$
			-	-

 <b>VDE Zeichengenehmigung</b> Approval ID: 40009031				
	Nominal Voltage $U_N$	Nominal Current $I_N$	Cross Section AWG	Cross Section $mm^2$

# Feed-through terminal block - ST 1,5-QUATTRO



3031186

<https://www.phoenixcontact.com/de/produkte/3031186>

	500 V	17.5 A	-	0.2 - 1.5
--	-------	--------	---	-----------



**cULus Recognized**  
Approval ID: E60425

	Nominal Voltage $U_N$	Nominal Current $I_N$	Cross Section AWG	Cross Section $mm^2$
Use group B				
	300 V	15 A	26 - 14	-
Use group C				
	300 V	15 A	26 - 14	-
Use group D				
	600 V	5 A	26 - 14	-

**DNV**

Approval ID: TAE00001CS

	Nominal Voltage $U_N$	Nominal Current $I_N$	Cross Section AWG	Cross Section $mm^2$
			-	-



**ATEX**

Approval ID: KEMA01ATEX2129U

	Nominal Voltage $U_N$	Nominal Current $I_N$	Cross Section AWG	Cross Section $mm^2$
Type examination certificate	440 V	17.5 A	-	0.08 - 1.5



**EAC Ex**

Approval ID: RU C-DE.HA91.B.00066



**IECEX**

Approval ID: IECEX KEM 06.0043U

	Nominal Voltage $U_N$	Nominal Current $I_N$	Cross Section AWG	Cross Section $mm^2$
	440 V	17.5 A	-	0.08 - 1.5



**CCC**

Approval ID: 2020322313000621



**NEPSI**

Approval ID: GYJ20.1193U

# Feed-through terminal block - ST 1,5-QUATTRO



3031186

<https://www.phoenixcontact.com/de/produkte/3031186>

## Classifications

### ECLASS

ECLASS-9.0	27141120
ECLASS-10.0.1	27141120
ECLASS-11.0	27141120

### ETIM

ETIM 8.0	EC000897
----------	----------

### UNSPSC

UNSPSC 21.0	39121400
-------------	----------

# Feed-through terminal block - ST 1,5-QUATTRO



3031186

<https://www.phoenixcontact.com/de/produkte/3031186>

## Environmental Product Compliance

China RoHS	Environmentally friendly use period: unlimited = EFUP-e
	No hazardous substances above threshold values

# Feed-through terminal block - ST 1,5-QUATTRO

3031186

<https://www.phoenixcontact.com/de/produkte/3031186>

## Accessories

 Note: Applying some accessories below might limit this product.

### Plug-in bridge

Plug-in bridge - FBS 2-4 - 3030116

<https://www.phoenixcontact.com/de/produkte/3030116>



Plug-in bridge, pitch: 4.2 mm, color: red

 Max. current carrying capacity: 17.5 A

### Plug-in bridge

Plug-in bridge - FBS 3-4 - 3030129

<https://www.phoenixcontact.com/de/produkte/3030129>



Plug-in bridge, pitch: 4.2 mm, color: red

 Max. current carrying capacity: 17.5 A

# Feed-through terminal block - ST 1,5-QUATTRO

3031186

<https://www.phoenixcontact.com/de/produkte/3031186>



## Plug-in bridge

Plug-in bridge - FBS 4-4 - 3030132

<https://www.phoenixcontact.com/de/produkte/3030132>



Plug-in bridge, pitch: 4.2 mm, color: red

 Max. current carrying capacity: 17.5 A

---

## Plug-in bridge

Plug-in bridge - FBS 5-4 - 3030145

<https://www.phoenixcontact.com/de/produkte/3030145>



Plug-in bridge, pitch: 4.2 mm, color: red

 Max. current carrying capacity: 17.5 A

# Feed-through terminal block - ST 1,5-QUATTRO

3031186

<https://www.phoenixcontact.com/de/produkte/3031186>

## Plug-in bridge

Plug-in bridge - FBS 10-4 - 3030158

<https://www.phoenixcontact.com/de/produkte/3030158>



Plug-in bridge, pitch: 4.2 mm, color: red

 Max. current carrying capacity: 17.5 A

---

## Plug-in bridge

Plug-in bridge - FBS 20-4 - 3030352

<https://www.phoenixcontact.com/de/produkte/3030352>



Plug-in bridge, pitch: 4.2 mm, color: red

 Max. current carrying capacity: 17.5 A

---

# Feed-through terminal block - ST 1,5-QUATTRO

3031186

<https://www.phoenixcontact.com/de/produkte/3031186>

## Plug-in bridge

Plug-in bridge - FBS 2-4 BU - 3030117

<https://www.phoenixcontact.com/de/produkte/3030117>



Plug-in bridge, pitch: 4.2 mm, color: blue

 Max. current carrying capacity: 17.5 A

---

## Plug-in bridge

Plug-in bridge - FBS 3-4 BU - 3030130

<https://www.phoenixcontact.com/de/produkte/3030130>



Plug-in bridge, pitch: 4.2 mm, color: blue

 Max. current carrying capacity: 17.5 A

---



# Feed-through terminal block - ST 1,5-QUATTRO

3031186

<https://www.phoenixcontact.com/de/produkte/3031186>



## Plug-in bridge

Plug-in bridge - FBS 4-4 BU - 3030133

<https://www.phoenixcontact.com/de/produkte/3030133>



Plug-in bridge, pitch: 4.2 mm, color: blue

 Max. current carrying capacity: 17.5 A

---

## Plug-in bridge

Plug-in bridge - FBS 5-4 BU - 3030146

<https://www.phoenixcontact.com/de/produkte/3030146>



Plug-in bridge, pitch: 4.2 mm, color: blue

 Max. current carrying capacity: 17.5 A

# Feed-through terminal block - ST 1,5-QUATTRO

3031186

<https://www.phoenixcontact.com/de/produkte/3031186>



## Plug-in bridge

Plug-in bridge - FBS 10-4 BU - 3036851

<https://www.phoenixcontact.com/de/produkte/3036851>



Plug-in bridge, pitch: 4.2 mm, color: blue

 Max. current carrying capacity: 17.5 A

---

## Plug-in bridge

Plug-in bridge - FBS 20-4 BU - 3030353

<https://www.phoenixcontact.com/de/produkte/3030353>

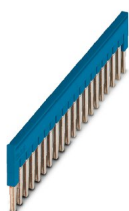

Plug-in bridge, pitch: 4.2 mm, color: blue

 Max. current carrying capacity: 17.5 A

# Feed-through terminal block - ST 1,5-QUATTRO

3031186

<https://www.phoenixcontact.com/de/produkte/3031186>



## Plug-in bridge

Plug-in bridge - FBS 2-4 GY - 3030118

<https://www.phoenixcontact.com/de/produkte/3030118>



Plug-in bridge, pitch: 4.2 mm, color: gray

 Max. current carrying capacity: 17.5 A

---

## Plug-in bridge

Plug-in bridge - FBS 3-4 GY - 3030131

<https://www.phoenixcontact.com/de/produkte/3030131>



Plug-in bridge, pitch: 4.2 mm, color: gray

 Max. current carrying capacity: 17.5 A

# Feed-through terminal block - ST 1,5-QUATTRO

3031186

<https://www.phoenixcontact.com/de/produkte/3031186>



## Plug-in bridge

Plug-in bridge - FBS 4-4 GY - 3030134

<https://www.phoenixcontact.com/de/produkte/3030134>



Plug-in bridge, pitch: 4.2 mm, color: gray

 Max. current carrying capacity: 17.5 A

---

## Plug-in bridge

Plug-in bridge - FBS 5-4 GY - 3030147

<https://www.phoenixcontact.com/de/produkte/3030147>



Plug-in bridge, pitch: 4.2 mm, color: gray

 Max. current carrying capacity: 17.5 A

# Feed-through terminal block - ST 1,5-QUATTRO

3031186

<https://www.phoenixcontact.com/de/produkte/3031186>

## Reducing bridge

Reducing bridge - RB ST (2,5/4)-1,5 - 3038943

<https://www.phoenixcontact.com/de/produkte/3038943>



Reducing bridge, pitch: 7.1 mm, color: red

 Max. current carrying capacity: 24 A

---

## End cover

End cover - D-ST 2,5-QUATTRO - 3030514

<https://www.phoenixcontact.com/de/produkte/3030514>

End cover, length: 72.2 mm, width: 2.2 mm, height: 29.1 mm, color: gray



# Feed-through terminal block - ST 1,5-QUATTRO

3031186

<https://www.phoenixcontact.com/de/produkte/3031186>

## DIN rail perforated

DIN rail perforated - NS 35/ 7,5 PERF 2000MM - 0801733

<https://www.phoenixcontact.com/de/produkte/0801733>



DIN rail perforated, acc. to EN 60715, material: Steel, galvanized, passivated with a thick layer, Standard profile, color: silver, Pack of 25 (50 m)

---

## Reducing plug

Reducing plug - RPS - 0201647

<https://www.phoenixcontact.com/de/produkte/0201647>



Reducing plug, color: gray

# Feed-through terminal block - ST 1,5-QUATTRO

3031186

<https://www.phoenixcontact.com/de/produkte/3031186>

## DIN rail, unperforated

DIN rail, unperforated - NS 35/ 7,5 UNPERF 2000MM - 0801681

<https://www.phoenixcontact.com/de/produkte/0801681>



DIN rail, unperforated, acc. to EN 60715, material: Steel, galvanized, passivated with a thick layer, Standard profile, color: silver, Pack of 25 (50 m)

---

## Partition plate

Partition plate - ATP-ST QUATTRO - 3030815

<https://www.phoenixcontact.com/de/produkte/3030815>

Partition plate, length: 90.9 mm, width: 2 mm, height: 45 mm, color: gray



# Feed-through terminal block - ST 1,5-QUATTRO

3031186

<https://www.phoenixcontact.com/de/produkte/3031186>

## DIN rail perforated

DIN rail perforated - NS 35/ 7,5 WH PERF 2000MM - 1204119

<https://www.phoenixcontact.com/de/produkte/1204119>



DIN rail perforated, acc. to EN 60715, material: Steel, Galvanized, white passivated, Standard profile, color: silver, Pack of 25 (50 m)

---

## Screwdriver

Screwdriver - SZF 0-0,4X2,5 - 1204504

<https://www.phoenixcontact.com/de/produkte/1204504>



Actuation tool, for ST terminal blocks, also suitable for use as a bladed screwdriver, size: 0.4 x 2.5 x 75 mm, 2-component grip, with non-slip grip



# Feed-through terminal block - ST 1,5-QUATTRO

3031186

<https://www.phoenixcontact.com/de/produkte/3031186>

## DIN rail, unperforated

DIN rail, unperforated - NS 35/ 7,5 WH UNPERF 2000MM-VPE 10 - 1204122

<https://www.phoenixcontact.com/de/produkte/1204122>



DIN rail, unperforated, acc. to EN 60715, material: Steel, Galvanized, white passivated, Standard profile, color: silver, Pack of 10 (20 m)

---

## Cover segment

Cover segment - DS-ST 2,5 - 3036602

<https://www.phoenixcontact.com/de/produkte/3036602>



End cover segments, large segment: 32.25 x 13.83 x 0.9, small segment: 22.65 x 11.65 x 0.9, color: gray

# Feed-through terminal block - ST 1,5-QUATTRO

3031186

<https://www.phoenixcontact.com/de/produkte/3031186>

## DIN rail, unperforated

DIN rail, unperforated - NS 35/ 7,5 AL UNPERF 2000MM - 0801704

<https://www.phoenixcontact.com/de/produkte/0801704>



DIN rail, unperforated, acc. to EN 60715, material: Aluminum, uncoated, Standard profile, color: silver, Pack of 25 (50 m)

---

## Warning cover

Warning cover - WST 1,5 - 3030958

<https://www.phoenixcontact.com/de/produkte/3030958>

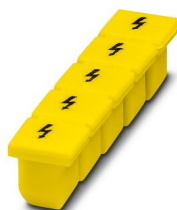

Warning cover, Strip, yellow, labeled, mounting type: plug in, for terminal block width: 4.25 mm, lettering field size: 4.25 x 3.55 mm, Number of individual labels: 5

# Feed-through terminal block - ST 1,5-QUATTRO

3031186

<https://www.phoenixcontact.com/de/produkte/3031186>

## DIN rail perforated

DIN rail perforated - NS 35/ 7,5 ZN PERF 2000MM - 1206421

<https://www.phoenixcontact.com/de/produkte/1206421>



DIN rail perforated, acc. to EN 60715, material: Steel, galvanized, Standard profile, color: silver, Pack of 25 (50 m)

---

## End cover

End cover - D-ST 2,5-QUATTRO-0,8 OG - 3030513

<https://www.phoenixcontact.com/de/produkte/3030513>

End cover, length: 72 mm, width: 0.8 mm, height: 29 mm, color: orange



# Feed-through terminal block - ST 1,5-QUATTRO

3031186

<https://www.phoenixcontact.com/de/produkte/3031186>

## DIN rail, unperforated

DIN rail, unperforated - NS 35/ 7,5 ZN UNPERF 2000MM - 1206434

<https://www.phoenixcontact.com/de/produkte/1206434>



DIN rail, unperforated, acc. to EN 60715, material: Steel, galvanized, Standard profile, color: silver, Pack of 25 (50 m)

---

## Mounting material

Mounting material - ST-IL - 3039900

<https://www.phoenixcontact.com/de/produkte/3039900>

Operating decal for the ST terminal block



# Feed-through terminal block - ST 1,5-QUATTRO

3031186

<https://www.phoenixcontact.com/de/produkte/3031186>

## DIN rail, unperforated

DIN rail, unperforated - NS 35/ 7,5 CU UNPERF 2000MM-VPE 10 - 0801762

<https://www.phoenixcontact.com/de/produkte/0801762>



DIN rail, unperforated, acc. to EN 60715, material: Copper, uncoated, Standard profile, color: copper-colored, Pack of 10 (20 m)

---

## End cap

End cap - NS 35/ 7,5 CAP - 1206560

<https://www.phoenixcontact.com/de/produkte/1206560>

DIN rail end piece, for DIN rail NS 35/7.5



# Feed-through terminal block - ST 1,5-QUATTRO

3031186

<https://www.phoenixcontact.com/de/produkte/3031186>

## DIN rail perforated

DIN rail perforated - NS 35/15 PERF 2000MM - 1201730

<https://www.phoenixcontact.com/de/produkte/1201730>



DIN rail perforated, similar to EN 60715, material: Steel, galvanized, passivated with a thick layer, Standard profile, color: silver, Pack of 25 (50 m)

---

## DIN rail, unperforated

DIN rail, unperforated - NS 35/15 UNPERF 2000MM - 1201714

<https://www.phoenixcontact.com/de/produkte/1201714>



DIN rail, unperforated, similar to EN 60715, material: Steel, galvanized, passivated with a thick layer, Standard profile, color: silver, Pack of 25 (50 m)

# Feed-through terminal block - ST 1,5-QUATTRO

3031186

<https://www.phoenixcontact.com/de/produkte/3031186>

## DIN rail perforated

DIN rail perforated - NS 35/15 WH PERF 2000MM - 0806602

<https://www.phoenixcontact.com/de/produkte/0806602>



DIN rail perforated, similar to EN 60715, material: Steel, Galvanized, white passivated, Standard profile, color: white, Pack of 25 (50 m)

---

## DIN rail, unperforated

DIN rail, unperforated - NS 35/15 WH UNPERF 2000MM-VPE 10 - 1204135

<https://www.phoenixcontact.com/de/produkte/1204135>



DIN rail, unperforated, similar to EN 60715, material: Steel, Galvanized, white passivated, Standard profile, color: silver, Pack of 10 (20 m)

# Feed-through terminal block - ST 1,5-QUATTRO

3031186

<https://www.phoenixcontact.com/de/produkte/3031186>

## DIN rail, unperforated

DIN rail, unperforated - NS 35/15 AL UNPERF 2000MM - 1201756

<https://www.phoenixcontact.com/de/produkte/1201756>



DIN rail, unperforated, similar to EN 60715, material: Aluminum, uncoated, Standard profile, color: silver

---

## DIN rail perforated

DIN rail perforated - NS 35/15 ZN PERF 2000MM - 1206599

<https://www.phoenixcontact.com/de/produkte/1206599>



DIN rail perforated, similar to EN 60715, material: Steel, galvanized, Standard profile, color: silver, Pack of 25 (50 m)



# Feed-through terminal block - ST 1,5-QUATTRO

3031186

<https://www.phoenixcontact.com/de/produkte/3031186>

## DIN rail, unperforated

DIN rail, unperforated - NS 35/15 ZN UNPERF 2000MM - 1206586

<https://www.phoenixcontact.com/de/produkte/1206586>



DIN rail, unperforated, similar to EN 60715, material: Steel, galvanized, Standard profile, color: silver, Pack of 25 (50 m)

---

## DIN rail, unperforated

DIN rail, unperforated - NS 35/15 CU UNPERF 2000MM-VPE 10 - 1201895

<https://www.phoenixcontact.com/de/produkte/1201895>



DIN rail, unperforated, similar to EN 60715, material: Copper, uncoated, Standard profile, color: copper-colored, Pack of 10 (20 m)

# Feed-through terminal block - ST 1,5-QUATTRO

3031186

<https://www.phoenixcontact.com/de/produkte/3031186>

## End cap

End cap - NS 35/15 CAP - 1206573

<https://www.phoenixcontact.com/de/produkte/1206573>

DIN rail end piece, for DIN rail NS 35/15



---

## DIN rail, unperforated

DIN rail, unperforated - NS 35/15-2,3 UNPERF 2000MM-VPE 10 - 1201798

<https://www.phoenixcontact.com/de/produkte/1201798>



DIN rail, unperforated, acc. to EN 60715, material: Steel, galvanized, passivated with a thick layer, Standard profile 2.3 mm, color: silver, Pack of 10 (20 m)

# Feed-through terminal block - ST 1,5-QUATTRO

3031186

<https://www.phoenixcontact.com/de/produkte/3031186>

## Zack marker strip

Zack marker strip - ZB 4 :UNBEDRUCKT - 0805001

<https://www.phoenixcontact.com/de/produkte/0805001>



Zack marker strip, Strip, white, unlabeled, can be labeled with: PLOTMARK, CMS-P1-PLOTTER, mounting type: snapped, for terminal block width: 4.2 mm, lettering field size: 4.2 x 10.5 mm, Number of individual labels: 10

---

## Zack marker strip

Zack marker strip - ZB 4 CUS - 0824951

<https://www.phoenixcontact.com/de/produkte/0824951>



Zack marker strip, can be ordered: Strip, white, labeled according to customer specifications, mounting type: snap into tall marker groove, for terminal block width: 4.2 mm, lettering field size: 4.2 x 10.5 mm, Number of individual labels: 10

# Feed-through terminal block - ST 1,5-QUATTRO

3031186

<https://www.phoenixcontact.com/de/produkte/3031186>

## Zack marker strip

Zack marker strip - ZB 4,LGS:FORTL.ZAHLEN - 0805739

<https://www.phoenixcontact.com/de/produkte/0805739>

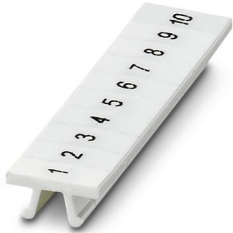

Zack marker strip, Strip, white, labeled, printed horizontally: consecutive numbers 1 ... 10, 11 ... 20, etc. up to 91 ... 100, mounting type: snapped, for terminal block width: 4.2 mm, lettering field size: 4.2 x 10.5 mm, Number of individual labels: 10

---

## Zack marker strip

Zack marker strip - ZB 4,QR:FORTL.ZAHLEN - 0805807

<https://www.phoenixcontact.com/de/produkte/0805807>

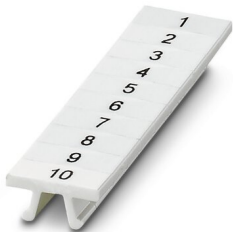

Zack marker strip, Strip, white, labeled, Printed vertically: consecutive numbers 1 ... 10, 11 ... 20, etc. up to 91 ... 100, mounting type: snapped, for terminal block width: 4.2 mm, lettering field size: 4.2 x 10.5 mm, Number of individual labels: 10

# Feed-through terminal block - ST 1,5-QUATTRO



3031186

<https://www.phoenixcontact.com/de/produkte/3031186>

## Marker for terminal blocks

Marker for terminal blocks - UC-TM 4 - 0818111

<https://www.phoenixcontact.com/de/produkte/0818111>



Marker for terminal blocks, Sheet, white, unlabeled, can be labeled with: BLUEMARK ID COLOR, BLUEMARK ID, BLUEMARK CLED, PLOTMARK, CMS-P1-PLOTTER, mounting type: snapped, for terminal block width: 4.2 mm, lettering field size: 3.6 x 10.5 mm, Number of individual labels: 120

---

## Marker for terminal blocks

Marker for terminal blocks - UC-TM 4 CUS - 0824573

<https://www.phoenixcontact.com/de/produkte/0824573>



Marker for terminal blocks, can be ordered: by sheet, white, labeled according to customer specifications, mounting type: snap into tall marker groove, for terminal block width: 4.2 mm, lettering field size: 3.6 x 10.5 mm, Number of individual labels: 120

# Feed-through terminal block - ST 1,5-QUATTRO

3031186

<https://www.phoenixcontact.com/de/produkte/3031186>

## Marker for terminal blocks

Marker for terminal blocks - UCT-TM 4 - 0828732

<https://www.phoenixcontact.com/de/produkte/0828732>



Marker for terminal blocks, Sheet, white, unlabeled, can be labeled with: TOPMARK NEO, TOPMARK LASER, BLUEMARK ID COLOR, BLUEMARK ID, BLUEMARK CLED, THERMOMARK PRIME, THERMOMARK CARD 2.0, THERMOMARK CARD, mounting type: snapped, for terminal block width: 4.2 mm, lettering field size: 3.6 x 10.5 mm, Number of individual labels: 84

---

## Marker for terminal blocks

Marker for terminal blocks - UCT-TM 4 CUS - 0829588

<https://www.phoenixcontact.com/de/produkte/0829588>



Marker for terminal blocks, can be ordered: by sheet, white, labeled according to customer specifications, mounting type: snap into tall marker groove, for terminal block width: 4.2 mm, lettering field size: 3.6 x 10.5 mm, Number of individual labels: 84

# Feed-through terminal block - ST 1,5-QUATTRO

3031186

<https://www.phoenixcontact.com/de/produkte/3031186>

## Zack Marker strip, flat

Zack Marker strip, flat - ZBF 4:UNBEDRUCKT - 0808587

<https://www.phoenixcontact.com/de/produkte/0808587>



Zack Marker strip, flat, Strip, white, unlabeled, can be labeled with: CMS-P1-PLOTTER, PLOTMARK, mounting type: snapped, for terminal block width: 4 mm, lettering field size: 4.2 x 5.2 mm, Number of individual labels: 10

---

## Zack Marker strip, flat

Zack Marker strip, flat - ZBF 4 CUS - 0825023

<https://www.phoenixcontact.com/de/produkte/0825023>



Zack Marker strip, flat, can be ordered: Strip, white, labeled according to customer specifications, mounting type: snap into flat marker groove, for terminal block width: 4.2 mm, lettering field size: 4.2 x 5.2 mm, Number of individual labels: 10

# Feed-through terminal block - ST 1,5-QUATTRO

3031186

<https://www.phoenixcontact.com/de/produkte/3031186>

## Zack Marker strip, flat

Zack Marker strip, flat - ZBF 4,LGS:FORTL.ZAHLEN - 0808626

<https://www.phoenixcontact.com/de/produkte/0808626>



Zack Marker strip, flat, Strip, white, labeled, printed horizontally: consecutive numbers 1 ... 10, 11 ... 20, etc. up to 91 ... 100, mounting type: snapped, for terminal block width: 4 mm, lettering field size: 4.2 x 5.2 mm, Number of individual labels: 10

---

## Zack Marker strip, flat

Zack Marker strip, flat - ZBF 4,QR:FORTL.ZAHLEN - 0808820

<https://www.phoenixcontact.com/de/produkte/0808820>

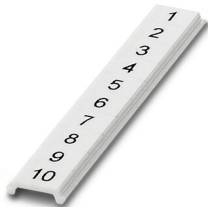

Zack Marker strip, flat, Strip, white, labeled, Printed vertically: consecutive numbers 1 ... 10, 11 ... 20, etc. up to 91 ... 100, mounting type: snapped, for terminal block width: 4 mm, lettering field size: 4.2 x 5.2 mm, Number of individual labels: 10



# Feed-through terminal block - ST 1,5-QUATTRO

3031186

<https://www.phoenixcontact.com/de/produkte/3031186>

## Zack Marker strip, flat

Zack Marker strip, flat - ZBF 4,LGS:GERADE ZAHLEN - 0810818

<https://www.phoenixcontact.com/de/produkte/0810818>



Zack Marker strip, flat, Strip, white, labeled, printed horizontally: consecutive even numbers 2 ... 20, 22 ... 40, etc. up to 82 ... 100, mounting type: snapped, for terminal block width: 4 mm, lettering field size: 5.15 x 4.15 mm, Number of individual labels: 10

---

## Zack Marker strip, flat

Zack Marker strip, flat - ZBF 4,LGS:UNGERADE ZAHLEN - 0810850

<https://www.phoenixcontact.com/de/produkte/0810850>



Zack Marker strip, flat, Strip, white, labeled, printed horizontally: Odd numbers 1 - 19, 21 - 39, etc. up to 81 - 99, mounting type: snapped, for terminal block width: 4 mm, lettering field size: 5.15 x 4.15 mm, Number of individual labels: 10

# Feed-through terminal block - ST 1,5-QUATTRO

3031186

<https://www.phoenixcontact.com/de/produkte/3031186>

## Marker for terminal blocks

Marker for terminal blocks - UC-TMF 4 - 0818166

<https://www.phoenixcontact.com/de/produkte/0818166>



Marker for terminal blocks, Sheet, white, unlabeled, can be labeled with: BLUEMARK ID COLOR, BLUEMARK ID, BLUEMARK CLED, PLOTMARK, CMS-P1-PLOTTER, mounting type: snapped, for terminal block width: 4.2 mm, lettering field size: 3.6 x 5.1 mm, Number of individual labels: 120

---

## Marker for terminal blocks

Marker for terminal blocks - UC-TMF 4 CUS - 0824630

<https://www.phoenixcontact.com/de/produkte/0824630>



Marker for terminal blocks, can be ordered: by sheet, white, labeled according to customer specifications, mounting type: snap into flat marker groove, for terminal block width: 4.2 mm, lettering field size: 3.6 x 5.1 mm, Number of individual labels: 120

# Feed-through terminal block - ST 1,5-QUATTRO

3031186

<https://www.phoenixcontact.com/de/produkte/3031186>

## Marker for terminal blocks

Marker for terminal blocks - UCT-TMF 4 - 0828742

<https://www.phoenixcontact.com/de/produkte/0828742>



Marker for terminal blocks, Sheet, white, unlabeled, can be labeled with: TOPMARK NEO, TOPMARK LASER, BLUEMARK ID COLOR, BLUEMARK ID, BLUEMARK CLED, THERMOMARK PRIME, THERMOMARK CARD 2.0, THERMOMARK CARD, mounting type: snapped, for terminal block width: 4.2 mm, lettering field size: 3.4 x 4.7 mm, Number of individual labels: 90

---

## Marker for terminal blocks

Marker for terminal blocks - UCT-TMF 4 CUS - 0829651

<https://www.phoenixcontact.com/de/produkte/0829651>



Marker for terminal blocks, can be ordered: by sheet, white, labeled according to customer specifications, mounting type: snap into flat marker groove, for terminal block width: 4.2 mm, lettering field size: 3.4 x 4.7 mm, Number of individual labels: 90

# Feed-through terminal block - ST 1,5-QUATTRO

3031186

<https://www.phoenixcontact.com/de/produkte/3031186>

## Test plugs

Test plugs - MPS-MT - 0201744

<https://www.phoenixcontact.com/de/produkte/0201744>



Test plugs, with solder connection up to 1 mm<sup>2</sup> conductor cross section, color: gray

---

## Insulating sleeve

Insulating sleeve - MPS-IH WH - 0201663

<https://www.phoenixcontact.com/de/produkte/0201663>



Insulating sleeve, color: white

# Feed-through terminal block - ST 1,5-QUATTRO

3031186

<https://www.phoenixcontact.com/de/produkte/3031186>

## Insulating sleeve

Insulating sleeve - MPS-IH RD - 0201676

<https://www.phoenixcontact.com/de/produkte/0201676>

Insulating sleeve, color: red



---

## Insulating sleeve

Insulating sleeve - MPS-IH BU - 0201689

<https://www.phoenixcontact.com/de/produkte/0201689>

Insulating sleeve, color: blue

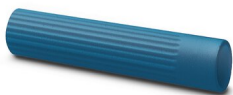

# Feed-through terminal block - ST 1,5-QUATTRO

3031186

<https://www.phoenixcontact.com/de/produkte/3031186>

## Insulating sleeve

Insulating sleeve - MPS-IH YE - 0201692

<https://www.phoenixcontact.com/de/produkte/0201692>

Insulating sleeve, color: yellow



---

## Insulating sleeve

Insulating sleeve - MPS-IH GN - 0201702

<https://www.phoenixcontact.com/de/produkte/0201702>

Insulating sleeve, color: green



# Feed-through terminal block - ST 1,5-QUATTRO

3031186

<https://www.phoenixcontact.com/de/produkte/3031186>

## Insulating sleeve

Insulating sleeve - MPS-IH GY - 0201728

<https://www.phoenixcontact.com/de/produkte/0201728>

Insulating sleeve, color: gray



---

## Insulating sleeve

Insulating sleeve - MPS-IH BK - 0201731

<https://www.phoenixcontact.com/de/produkte/0201731>

Insulating sleeve, color: black



# Feed-through terminal block - ST 1,5-QUATTRO

3031186

<https://www.phoenixcontact.com/de/produkte/3031186>

## Insulating sleeve

Insulating sleeve - ISH 1,5/0,2 - 3206131

<https://www.phoenixcontact.com/de/produkte/3206131>



Insulating sleeve, color: white

---

## Insulating sleeve

Insulating sleeve - ISH 1,5/0,5 - 3031034

<https://www.phoenixcontact.com/de/produkte/3031034>



Insulating sleeve, color: gray



# Feed-through terminal block - ST 1,5-QUATTRO

3031186

<https://www.phoenixcontact.com/de/produkte/3031186>

## Test adapter

Test adapter - PAI-4 - 3030925

<https://www.phoenixcontact.com/de/produkte/3030925>



Test adapter, Touch proof against unintentional direct contact according to DIN EN 50274 when plugged in, for 4 mm test plug and terminal blocks with 4.2 mm pitch, color: gray

---

## Test plugs

Test plugs - PS-4 - 3030970

<https://www.phoenixcontact.com/de/produkte/3030970>



Test plugs, Modular test plug, color: red

# Feed-through terminal block - ST 1,5-QUATTRO

3031186

<https://www.phoenixcontact.com/de/produkte/3031186>

## Spacer plate

Spacer plate - DP PS-4 - 3036712

<https://www.phoenixcontact.com/de/produkte/3036712>



Spacer plate, length: 22.4 mm, width: 4.2 mm, height: 29 mm, number of positions: 1, color: red

---

## End clamp

End clamp - CLIPFIX 35 - 3022218

<https://www.phoenixcontact.com/de/produkte/3022218>



Quick mounting end clamp for NS 35/7,5 DIN rail or NS 35/15 DIN rail, with marking option, width: 9.5 mm, color: gray

# Feed-through terminal block - ST 1,5-QUATTRO

3031186

<https://www.phoenixcontact.com/de/produkte/3031186>

## End clamp

End clamp - CLIPFIX 35-5 - 3022276

<https://www.phoenixcontact.com/de/produkte/3022276>



Quick mounting end clamp for NS 35/7,5 DIN rail or NS 35/15 DIN rail, with marking option, with parking option for FBS...5, FBS...6, KSS 5, KSS 6, width: 5.15 mm, color: gray

---

## End clamp

End clamp - E/NS 35 N - 0800886

<https://www.phoenixcontact.com/de/produkte/0800886>

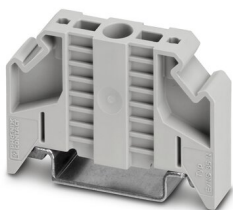

End clamp, width: 9.5 mm, color: gray

# Feed-through terminal block - ST 1,5-QUATTRO

3031186

<https://www.phoenixcontact.com/de/produkte/3031186>

## End clamp

End clamp - E/UK - 1201442

<https://www.phoenixcontact.com/de/produkte/1201442>

End clamp, material: PA, color: gray, Mounting on a DIN rail NS 32 or NS 35



---

## End clamp

End clamp - E/UK 1 - 1201413

<https://www.phoenixcontact.com/de/produkte/1201413>

End clamps, for supporting the ends of double-level and three-level terminal blocks, width: 10 mm, color: gray



---

Phoenix Contact 2022 © - all rights reserved  
<https://www.phoenixcontact.com>

PHOENIX CONTACT Deutschland GmbH  
Flachsmarktstraße 8  
D-32825 Blomberg  
+49 52 35/3-1 20 00  
[info@phoenixcontact.de](mailto:info@phoenixcontact.de)