

Cable feed-through plates - MH-27-MULTI-65-PV-BK



1424583

<https://www.phoenixcontact.com/pc/products/1424583>

Please be informed that the data shown in this PDF document is generated from our Online Catalog. Please find the complete data in the user documentation. Our General Terms of Use for Downloads are valid.



Cable feed-through plates, no. of conductors: 27, length: 154 mm, width: 56 mm, height: 18.5 mm, external cable diameter: 26x 3 mm ... 6 mm

Your advantages

- The panel cutouts of size B24 heavy-duty connectors can be used.

Cable feed-through plates - MH-27-MULTI-65-PV-BK



1424583

<https://www.phoenixcontact.com/pc/products/1424583>

Commercial Data

Item number	1424583
Packing unit	1 pc
Minimum order quantity	1 pc
Product Key	BF7CAX
Catalog Page	Page 683 (C-2-2019)
GTIN	4055626374864
Weight per Piece (including packing)	76.7 g
Weight per Piece (excluding packing)	76.7 g
Customs tariff number	39269097
Country of origin	FI

Cable feed-through plates - MH-27-MULTI-65-PV-BK



1424583

<https://www.phoenixcontact.com/pc/products/1424583>

Technical Data

Notes

General	incl. mounting screws
---------	-----------------------

Product properties

Product type	Cable feed-through
No. of conductors	27

Dimensions

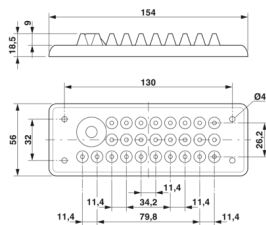
Dimensional drawing	
Width	56 mm
Height	18.5 mm
Length	154 mm
Drill hole distance, horizontal	130 mm
Drill hole distance, vertical	32 mm
Hole diameter	4 mm

Material specifications

Color	black
Material	TPE-SEBS
Material	PP (Core) TPE-SEBS (external material)
Flammability rating according to UL 94	V0

Connector

Material	TPE-SEBS
Material	TPE-SEBS

Cable / line

Cable structure

External cable diameter	26x 3 mm ... 6 mm 1x 10 mm ... 20 mm
-------------------------	---

Environmental and real-life conditions

Ambient conditions

Degree of protection	IP65
----------------------	------

Cable feed-through plates - MH-27-MULTI-65-PV-BK



1424583

<https://www.phoenixcontact.com/pc/products/1424583>

Ambient temperature (operation)	-40 °C ... 90 °C
---------------------------------	------------------

Mounting

Assembly instructions	M4 mounting screw, torque: 1.8 Nm, SW5 Allen key
	<p>The mounting screws included should be used for assembly.</p> <p>Assembly steps:</p> <ol style="list-style-type: none">1) Fix Multigates with the mounting screws provided (observe torque)2) Make a hole in the membrane (with a screwdriver) or cut off the tip of the cone3) Guide the cable through the opening (from the outside). Withdraw the cable approximately 20 mm (to improve strain relief).

Cable feed-through plates - MH-27-MULTI-65-PV-BK



1424583

<https://www.phoenixcontact.com/pc/products/1424583>

Drawings

Dimensional drawing

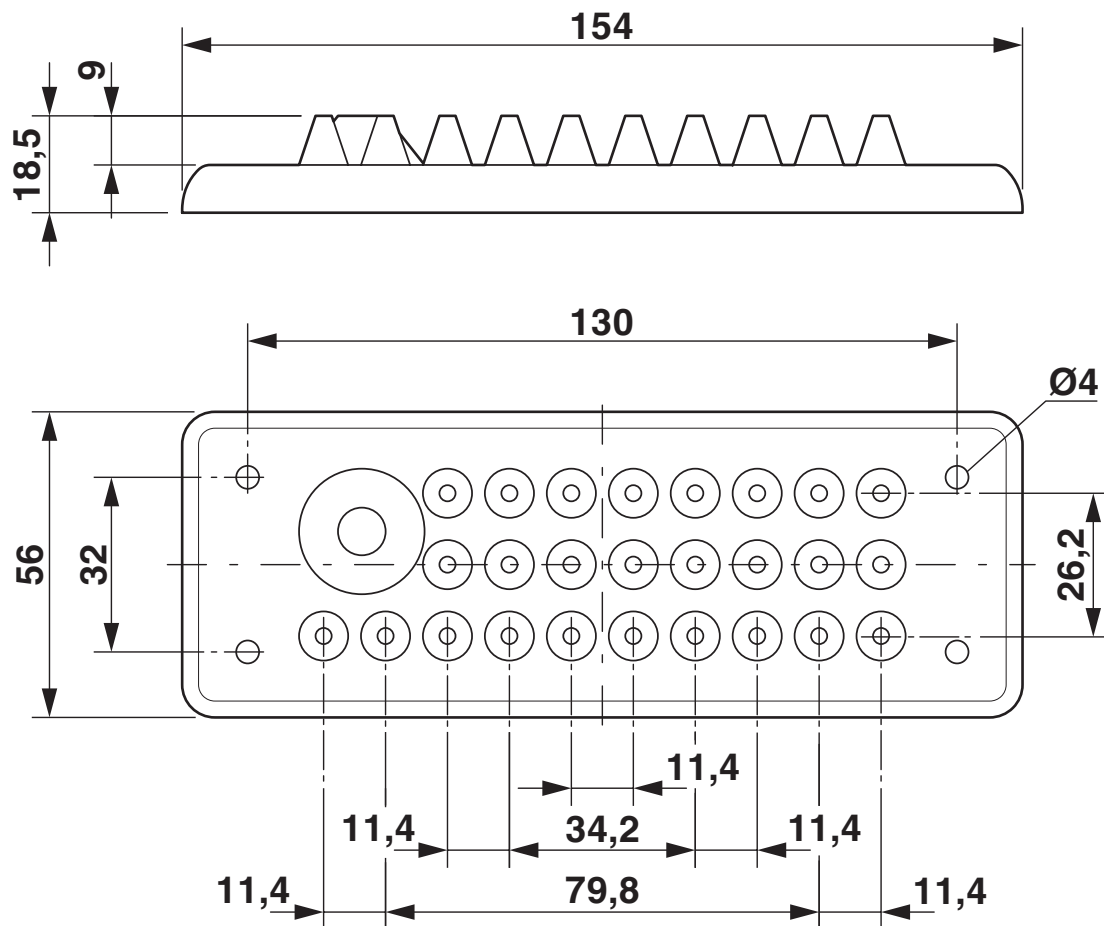

Dimensional drawing

Cable feed-through plates - MH-27-MULTI-65-PV-BK



1424583

<https://www.phoenixcontact.com/pc/products/1424583>

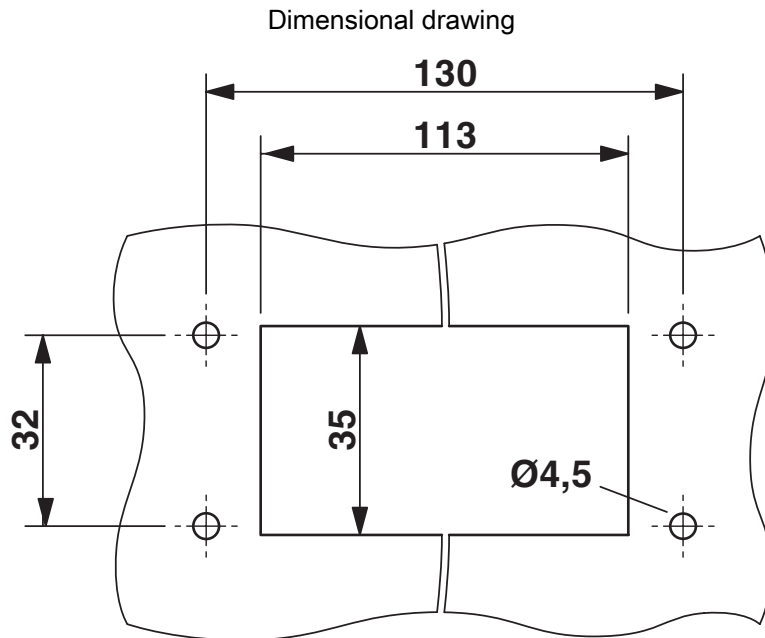

Wall cutout drawing

Cable feed-through plates - MH-27-MULTI-65-PV-BK



1424583

<https://www.phoenixcontact.com/pc/products/1424583>

Approvals

EAC **EAC**
Approval ID: EAC-Zulassung

EAC **EAC**
Approval ID: RU D-DE.HB35.B.00387

Cable feed-through plates - MH-27-MULTI-65-PV-BK



1424583

<https://www.phoenixcontact.com/pc/products/1424583>

Classifications

ECLASS

ECLASS-9.0	27400569
ECLASS-10.0.1	27400569
ECLASS-11.0	27400569

ETIM

ETIM 8.0	EC001004
----------	----------

UNSPSC

UNSPSC 21.0	31163000
-------------	----------

Cable feed-through plates - MH-27-MULTI-65-PV-BK



1424583

<https://www.phoenixcontact.com/pc/products/1424583>

Environmental Product Compliance

China RoHS	Environmentally friendly use period: unlimited = EFUP-e No hazardous substances above threshold values
------------	---

Phoenix Contact 2022 © - all rights reserved
<https://www.phoenixcontact.com>

PHOENIX CONTACT GmbH & Co. KG
Flachmarktstraße 8
D-32825 Blomberg
+49 (0) 5235-3 00
info@phoenixcontact.com